

Specification

Working Voltage: 3v

Standby Current: 2~6 UA

Power Source: Lithium battery CR-2032 x1

Operation Current: 1.0~5 mA□

Mini Therapeutic Massager

Model: 601

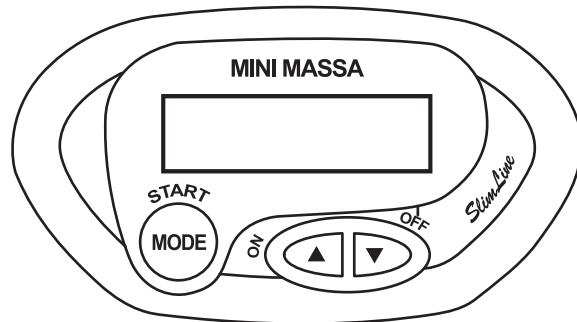

Thank you for purchasing Mini Therapeutic MASSAGER, Make sure to read this instruction manual thoroughly and carefully before using and also keep it handy for your reference. [REDACTED]

This device is designed with a slim and compact size for easy travel anywhere at anytime also relax pain of muscle and slimming aid [REDACTED]

Caution

[REDACTED]

- * Do not use with people who has heart disease or arrhythmias
- * Do not use on pregnant woman
- * Do not apply device on your head or heart portion
- * Press "mode" button to stop output immediately, if device output too strong to what you can withstand

Description Of Components

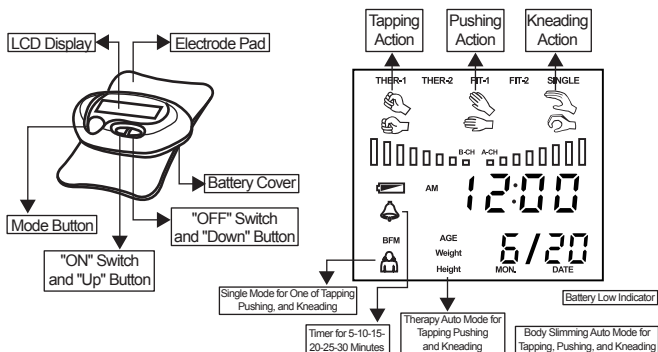

Battery Installation and Replacement

Remove Battery Seal

1. The lithium battery CR-2032 pre-install in the unit, please pull out the insulation tab before using. (FIG, 1)[REDACTED]
2. Tear off the protection sheet under the electrode pad and stick to the portion of your body where needs to massage.(follow the"operation" section for setting)□

Battery Replacement [REDACTED]

When display indication with low battery [REDACTED] , please replace a new lithium CR-2032 battery

1. Slide the battery cover out in the direction of arrow (FIG, 2)
2. Install a lithium battery CR-2032 into battery compartment with ⊕ polarity face up, push down the battery to be firmly fixed into battery plate (FIG, 2)
3. Replace the battery cover

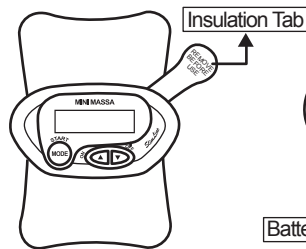

Fig.1

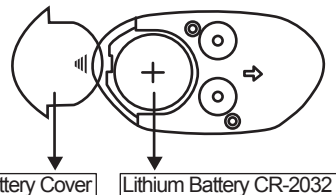

Fig.2

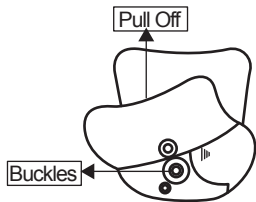

Fig.3

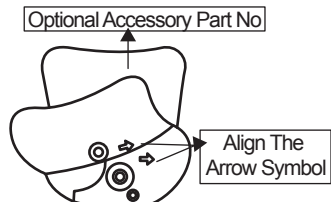

Fig.4

Electrode pad replacement

Over period of time, the pad may become less sticky, to order the optional accessory part on from dealer for replacement□□□□□□

1. To pull off 2 clip buckles between device and electrode pad (FIG, 3)
2. Align the arrow symbol" ⇨ " on the pad to the" ⇨ " on the bottom of unit and buckles up by pressing on the back of pad (FIG.4)

□

Operation

1. Press and Hold "▲" button until all number segments turn on for a moment, then one of the mode icon "THER", "SHARP", "SINGLE" start blinking
2. Press "▲" or "▼" button to select the mode you desired
3. Press "Mode" button to enter timer setting
4. Press "▲" or "▼" , timer will roll up or down among 5-10-15-20-25-30 minutes, to select a timer you want□
5. Press "Mode" button to confirm the timer and start operation

6. Press "▲" button to increase intensity level to a proper level you feel comfortable, or press "▼" button to decrease the level, (There are total 8 intensity levels every 2 levels increment will add up one segment of level indication)
7. Press "mode" button to exit anytime during the massage period and you can re-setting massage mode again
- 8: Press and Hold "▼" button to turn off the device or unit auto off in thirty second after the times up of set timer□

Note: when battery icon □ shown, the device will stop operation and only blinking battery icon □, please refer to battery replacement and replace with a new lithium battery type CR-2032

Maintenance

- * There is a PVC plate (included) for you to restore the device for future re-use be sure to stick the unit on the shining side of plate
- * Do not disassemble, repair, or remodel the main unit
- * The device will not be used for a long period , please take out battery
- * Keep the device out of the reach of children
- * Avoid placing the device where directly sunlight, high humidity or high temperature
- * Do not drop device and avoid suddenly shock
- * Do not use thinner or any chemicals solvent to clear the device, but use a damp cloth to wipe up
- * Please make sure to keep your skin dry and clean before stick device on skin surface
- * For some sensitive skin, it may appear ruddy skin on the apply position , this is normal and will disappear within about an hour□

Troubleshooting

If you have trouble while using the device, please check the following points

Error	Possible cause	How to correct
No output massage	-If Insulation tab take out -Battery worn out -Incorrect Battery polarity installation	-Please take out insulation tab -Replace new battery -Install battery in the correct polarity with face up
Massage output weak	-If electrode pad fully contact to skin -If electrode pad is dusty -If battery low icon  on	-Electrode pad re-stick to fully contact to skin -Please contact dealer to order a new electrode pad for replaement -Replace a new battery CR-2032
Sting feeling	-If attached position is proper -Too strong output intensive levels	-Exchange electrode pad position -Adjust to lower output intensive levels
Nothing display in LCD	-If Battery power low	-Replace new battery
when you push on button	-If Incorret Battery polarity installation Battery not be properly installed	-Reinstall battery in the correct polarity -Remove battery and wait for 1 minute to reinstall again